

RETENTION KNOBS

For CAT40, CAT50, BT30, BT40 & BT50

CAT40 Retention Knobs 5/8 - 11

EDP	Description	DWG.	T	A	L	HOLE?	Socket
X7032A	40E-A / A-45-.440(C.281)	A - A	.625-11	45	1.5	Y	RKW40
X7033A	40E-A / A-45-.440	A - A	.625-11	45	1.5	N	RKW40
X7034A	BOSTON DIGITAL	SPEC	.625-11	15	1.5	N	N/A
X7035A	40E-A / PT-45-1.000	A - PT	.625-11	45	2.265	N	RKW40M
X7036A	40E-A / PT-45-1.139	A - PT	.625-11	45	2.25	N	RKW40M
X7037A	40E-A / PT-45-1.139(C.157)	A - PT	.625-11	45	2.25	Y	RKW40
X7038A	40E-BT (A) / PT-45-.988	BT - PT	.625-11	45	2.25	N	RKW40
X7039A	40E-BT (A) / PT-60-.988	BT - PT	.625-11	60	2.25	N	RKW40
X7040A	40E-A / PT-60-.988	A - PT	.625-11	60	2.125	N	RKW40
X7041A	40E-BT (A) / PT-90-.988	BT - PT	.625-11	90	2.25	N	RKW40
X7042A	40E-A / PT-90-.988	A - PT	.625-11	90	2.125	N	RKW40
X7043A	40E-A / PT-45-.988C.156	A - PT	.625-11	45	2.125	Y	RKW40
X7044A	40E-A / PT-45-.988	A - PT	.625-11	45	2.125	N	RKW40
X7045A	40E-BT / SP-90-.777	M - 1	.625-11	90	2.037	N	RKW40
X7046A	40E-BT (A) / A-45-.440(C.281)	BT - A	.625-11	45	1.624	Y	RKW40
X7047A	40E-BT (A) / A-45-.440	BT - A	.625-11	45	1.624	N	RKW40
X7048A	40E-BT (A) / PT-45-.988(C.200)	BT - PT	.625-11	45	2.25	Y	RKW40
X7049A	40E-A (A) / PT-45-.7066(C.079)	A - PT	.625-11	45	1.889	Y	RKW40
X7050A	40E-A / I(A)-15-.792	I - I (A)	.625-11	15	1.89	N	RKW40
X7051A	40E-A (A)-O / I(A)-15-.792(C.281)	I - I (A)	.625-11	15	1.89	Y	RKW40
X7052A	40E-BT / PT-60-.988(C.128)	BT - PT	.625-11	60	2.25	Y	RKW40
X7053A	40E-A / .124 / PT-45-.988	A - PT	.625-11	45	2.125	N	RKW40
X7054A	40E-A / .124 / PT-60-.988	A - PT	.625-11	60	2.125	N	RKW40
X7055A	40E-A / .124 / PT-90-.988	A - PT	.625-11	90	2.125	N	RKW40
X7056A	40E-A / .124 / PT-45-.988(C.187)	A - PT	.625-11	45	2.124	Y	RKW40
X7057A	40E-A-OP / .124 / PT-45-.988(C.187)-OID	A - PT	.625-11	45	2.124	Y	RKW40
X7058A	40E-BT / PT-90-.707	BT - PT	.625-11	90	1.97	N	RKW40
X7059A	40E-A-OP / A-45-.440(C.160)	BT - A	.625-11	45	1.624	Y	RKW40
X7060A	40E-BT / PT-60-.481	BT - SP	.625-11	60	1.732	N	RKW40
X7061A	40E-BT (BT) / I(A)-15-.9035(C.281)	I - I (A)	.625-11	15	2.126	Y	RKW40
X7062A	40E-BT(A) / PT-90-.988(C.224)	BT - PT	.625-11	90	2.25	Y	RKW40
X7063A	40E-I (A) / I(B)-45-.433(C.281)	I - I (B)	.625-11	45	1.758	Y	RKW40
X7064A	40E-A / D(A)-15-.7874(C.281)	D - D (A)	.625-11	15	1.88	Y	RKW40
X7065A	40E-A / D(A)-15-.7874	D - D (A)	.625-11	15	1.88	N	RKW40

CAT50 Retention Knobs for Tool Shank 1" - 8

EDP	Description	DWG.	T	A	L	HOLE?	Socket
X7066A	50E-A / A-45-.700(C.500)	A - A	1.00-8	45	2.3	Y	RKW50
X7067A	50E-A / A-45-.700(C.468)	A - A	1.00-8	45	2.3	Y	RKW50
X7068A	50E-A / A-45-.700	A - A	1.00-8	45	2.3	N	RKW50
X7069A	50E-A / SP-40-1.025	LUCAS	1.00-8	40	2.96	N	N/A
X7070A	50E-A / A-45-.700(C.468)	A - A	1.00-8	45	2.3	Y	RKW50M
X7071A	50E-BT / PT-45-1.384	BT - PT	1.00-8	45	3.35	N	RKW50
X7072A	50E-BT / PT-60-1.384	BT - PT	1.00-8	60	3.35	N	RKW50
X7073A	50E-A / PT-60-1.384	A - PT	1.00-8	60	3.08	N	RKW50
X7074A	50E-BT / PT-90-1.384	BT - PT	1.00-8	90	3.35	N	RKW50
X7075A	50E-A / PT-90-1.384	A - PT	1.00-8	90	3.08	N	RKW50
X7076A	50E-A / PT-45-1.384(C.312)	A - PT	1.00-8	45	3.08	Y	RKW50
X7077A	50E-A / PT-45-1.384	A - PT	1.00-8	45	3.08	N	RKW50
X7078A	50E-BT / M2-90-1.384	M - 2	1.00-8	90	3.35	N	RKW40
X7079A	50E-BT / A-45-.700(C.390)-OF	BT - A	1.00-8	45	2.3	Y	RKW50M
X7080A	50E-A / A-45-.700(C.390)-OID	A - A	1.00-8	45	2.303	Y	RKW50M
X7081A	50E-BT / PT-45-1.384(C.390)	BT - PT	1.00-8	45	3.355	Y	RKW50
X7082A	50E-BT-OP / PT-45-1.384(C.236)	BT - PT	1.00-8	45	3.355	Y	RKW50
X7083A	50E-BT-OP / PT-45-1.384(C.236)-OID	BT - PT	1.00-8	45	3.355	Y	RKW50
X7084A	50E-BT / PT-60-1.384(C.335)	BT - PT	1.00-8	60	3.355	Y	RKW50
X7085A	50E-A / PT-90-.903	A - PT	1.00-8	90	2.519	N	RKW50M
X7086A	50E-A / PT-90-.903(C.250)	A - PT	1.00-8	90	2.519	Y	RKW50M
X7087A	50E-A / PT-90-.903(C.315)	A - PT	1.00-8	90	2.519	Y	RKW50M
X7088A	50E-A-OP / PT-60-1.384(C.236)	A - PT	1.00-8	60	3.353	Y	RKW50
X7089A	50E-BT / PT-90-1.384(C.250)	BT - PT	1.00-8	90	3.35	Y	RKW50
X7090A	50E-A / I(A)-15-.9901	A - ISO	1.00-8	15	2.911	N	RKW50
X7091A	50E-A / SP-.141R-1.260	SPECIAL	1.00-8	.141R	2.861	N	N/A
X7092A	50E-A / SP-.141R-2.260	SPECIAL	1.00-8	.141R	3.861	N	N/A
X7093A	50E-A / D(A)-15-.984(C.468)	D - D (A)	1.00-8	15	2.64	Y	RKW50M
X7094A	50E-A / D(A)-15-.984	D - D (A)	1.00-8	15	2.64	N	RKW50M

BT30 Retention Knobs for Tool Shank M12 x 1.75

EDP	Description	DWG.	T	A	L	HOLE?	Socket
X7000A	30M-BT / PT-45-.707	BT - PT	M12X1.75	45	1.69	N	RKW30M
X7001A	30M-BT / PT-60-.707	BT - PT	M12X1.75	60	1.69	N	RKW30M
X7002A	30M-BT / PT-45-.707(C.110)	BT - PT	M12X1.75	45	1.69	Y	RKW30M

BT40 Retention Knobs for Tool Shank M16 x 2.0

EDP	Description	DWG.	T	A	L	HOLE?	Socket
X7003A	40M-BT (1) / A-45-.440(C.281)	A / A	M16X2.0	45	1.624	Y	RKW40
X7004A	40M-A (1)-P / A-45-.440(C.281)	A / A	M16X2.0	45	1.5	Y	RKW40
X7005A	40M-A (1) / A-45-.440	A / A	M16X2.0	45	1.5	N	RKW40
X7006A	40M-BT / A-45-.552	BT - A	M16X2.0	45	1.612	N	RKW40
X7007A	40M-BT / A-45-.552(C.281)	BT - A	M16X2.0	45	1.612	Y	RKW40
X7008A	40M-BT / PT-45-1.251	BT - PT	M16X2.0	45	2.534	N	RKW40M
X7009A	40M-BT / PT-45-1.251(C.141)	BT - PT	M16X2.0	45	2.534	Y	RKW40M
X7010A	40M-BT / PT-45-1.100	BT - PT	M16X2.0	45	2.36	N	RKW40
X7011A	40M-BT / PT-60-1.100	BT - PT	M16X2.0	60	2.36	N	RKW40
X7012A	40M-BT / PT-90-1.100	BT - PT	M16X2.0	90	2.36	N	RKW40
X7013A	40M-BT / PT-45-1.100(C.197)	BT - PT	M16X2.0	45	2.36	Y	RKW40
X7014A	40M-BT / PT-60-1.100(C.197)	BT - PT	M16X2.0	60	2.36	Y	RKW40
X7015A	40M-BT / PT-90-1.100(C.197)	BT - PT	M16X2.0	90	2.36	Y	RKW40
X7016A	40M-BT / I(A)-15-.9035	BT - I (A)	M16X2.0	15	2.126	N	RKW40
X7017A	40M-BT / I(A)-15-.9035(C.281)	BT - I (A)	M16X2.0	15	2.126	Y	RKW40
X7018A	40M-D / D(A)-15-.787(C.281)	D - D (A)	M16X2.0	15	2.136	Y	RKW40
X7019A	40M-D / D(A)-15-.787	D - D (A)	M16X2.0	15	2.136	N	RKW40

BT50 Retention Knobs for Tool Shank M24 x 3.0

EDP	Description	DWG.	T	A	L	HOLE?	Socket
X7020A	50M-A / A-45-.700(C.468)	A - A	M24X3.0	45	2.3	Y	RKW50
X7021A	50M-A-P / A-45-.700	A - A	M24X3.0	45	2.3	N	RKW50
X7022A	50M-A-P / A-45-.700(C.468)	A - A	M24X3.0	45	2.3	Y	RKW50
X7023A	50M-BT / PT-45-1.376	BT - PT	M24X3.0	45	3.35	N	RKW50M
X7024A	50M-BT / PT-60-1.376	BT - PT	M24X3.0	60	3.35	N	RKW50M
X7025A	50M-BT / PT-90-1.376	BT - PT	M24X3.0	90	3.35	N	RKW50M
X7026A	50M-A / A-45-.700(C.390)-OF	BT - A	M24X3.0	45	2.58	Y	RKW50M
X7027A	50M-BT / PT-45-1.376(C.236)	BT - PT	M24X3.0	45	3.35	Y	RKW50M
X7028A	50M-BT / PT-60-1.376(C.312)	BT - PT	M24X3.0	60	3.35	Y	RKW50M
X7029A	50M-BT / PT-90-1.376(C.250)	BT - PT	M24X3.0	90	3.35	Y	RKW50M
X7030A	50M-D / D(A)-15-.984(C.468)	D - D (A)	M24X3.0	15	2.92	Y	RKW50M
X7031A	50M-D / D(A)-15-.984	D - D (A)	M24X3.0	15	2.92	N	RKW50M

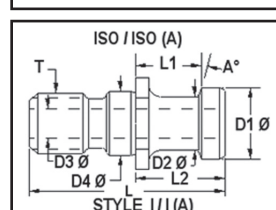
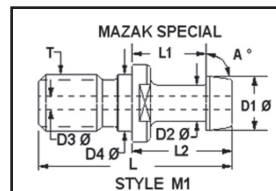
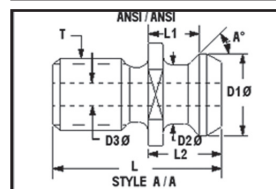
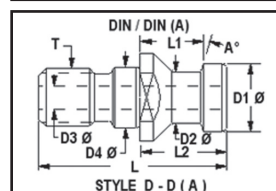
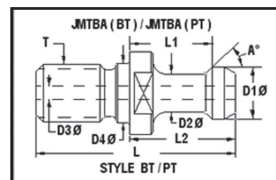

**CALL US WITH YOUR MACHINE MAKE & MODEL.
WHETHER YOU NEED COOLANT THRU OR SOLID,
WE WILL FIND THE RETENTION KNOB FOR YOU!**



Retention Knob Sockets

EDP	Part Number	Taper	1/2: Drive Socket Fits Retention Knob Type	Thread Size	Shoulder Dia Max.	Wrench Size Max.
X14981A	RKW30M	30	JMTBA	M - 12	0.675	0.511
X14983A	RKW40	40	ANSI, JMTBA, ISO, TYPE A, DIN	5/8-11 UNC	0.944	0.755
X14987A	RKW50	50	ANSI, JMTBA, ISO, TYPE A, DIN	1-8 UNC	1.45	1.255
X14988A	RKW50M	50	JMTBA, ISO, TYPE A & B, DIN	M - 24	1.5	1.185

TOOL HOLDER ACCESSORIES

Carts, Towers, Racks & Holding Fixtures

CNC Tool Scoot™



27-5/16" W x 18-5/16"D x 36 H
Shipping Weight 65 lbs.
(Per Tool Tower)

- Holds 48 toolholders for 30, 40 tapers
- Holds 36 toolholders for 50 taper
- 2 storage trays with protective lining inside
- Durable nylon inserts to help prevent tool damage
- New extra tray supports for better stability
- Interlocking side panel construction adds strength
- Heavy duty 5" x 1-1/4" casters load rated at 1000 lbs.
- Keep tools cleaner than open end carts
- Angled tray for easy, quick tool access from either side
- Two position adjustable tray holder
- Solid side panels for maximum strength & stability
- Heavy gauge, all steel infra red/baked epoxy finish

 **30 Taper - EDP H13930A**

 **40 Taper - EDP H13940A**

 **50 Taper - EDP H13950A**

CNC Tool Towers



18" W x 35-1/4"D x 35 H
Shipping Weight 79 lbs.
(Per Tool Cart)

- Individual units are 3' tall
- Optional stacking kit is sold separately
- Nylon inserts protect each tool holder
- Sturdy 16 gauge steel construction
- Optional tool lock tray can be mounted on either side panel
- Tool Tower should be bolted to the floor for additional security

 **30 Taper - EDP H13830A**

 **40 Taper - EDP H13840A**

 **50 Taper - EDP H13850A**

ER COLLET NEW Trays



Up to 40 Collets per Tray

Individual Trays for All ER Collet Sizes Available

- Protect your expensive investments with high impact plastic trays
- Sliding see thru plastic cover
- Up to 40 collets per tray - holds a full set plus special & metric sizes
- Angled seat location to secure collet

ER11 Collet Tray EDP 13915A

ER16 Collet Tray EDP 13916A

ER20 Collet Tray EDP 13917A

ER25 Collet Tray EDP 13918A

ER32 Collet Tray EDP 13919A

ER40 Collet Tray EDP 13920A



CNC Holders

- Protect your expensive investments with high impact plastic trays
- 10 holders per tray

CNC 30 Holder EDP 13887A

CNC 40 Holder EDP 13888A

TOOL HOLDER Fixtures

Made to be bolted down or for use in vises.



All tool holder fixtures fit CAT, BT, ISO & NMTB shank tooling.

EDP	Tightening Fixture	Taper	B	C	Key
B50209A	30 Taper Tooling	30	3.91"	3.00"	0.62"
B50210A	40 Taper Tooling	40	4.65"	3.00"	0.62"
B50211A	50 Taper Tooling	50	6.35"	4.00"	1.00"

Weler, ER Collet Chucks & Tapping

CAT40 WELER



SAVINGS
vs Buying Individually
\$225

KIT INCLUDES 8 PIECES

20mm CAT40 Weler Chuck	15021	POPULAR REDUCTION SLEEVES
20mm Weler Wrench	15048	1/8" 15050
20mm Reduction Sleeve Extractor	15179	1/4" 15052
		3/8" 15049
		1/2" 15055
		5/8" 15056

\$629⁹⁵ EDP 15100A

Size 1 Rigid TAP ADAPTERS



SAVINGS
vs Buying Individually
\$20

KIT INCLUDES 5 PIECES

POPULAR SIZES	5/16 11607
#10 11604	3/8 11608
1/4 11606	1/2 11612

\$128⁹⁵ EDP 11273A

ER16 Collet CAT40 CHUCKS



SAVINGS
vs Buying Individually
\$240

KIT INCLUDES 3 PIECES

2 1/2" 51013
3" 11006
6" 11007

\$298⁹⁵ EDP 11277A

BT40 WELER



SAVINGS
vs Buying Individually
\$305

KIT INCLUDES 8 PIECES

20mm BT40 Weler Chuck	15037	POPULAR REDUCTION SLEEVES
20mm Weler Wrench	15048	1/8" 15050
20mm Reduction Sleeve Extractor	15179	1/4" 15052
		3/8" 15049
		1/2" 15055
		5/8" 15056

\$629⁹⁵ EDP 15099A

Size 1 Torque TAP ADAPTERS



SAVINGS
vs Buying Individually
\$50

KIT INCLUDES 5 PIECES

POPULAR SIZES	5/16 11805
#10 11802	3/8 11806
1/4 11804	1/2 11808

\$348⁹⁵ EDP 11274A

ER20 Collet CAT40 CHUCKS



SAVINGS
vs Buying Individually
\$250

KIT INCLUDES 3 PIECES

2 1/2" 17391
4" 51014
6" 51015

\$328⁹⁵ EDP 11278A

CAT40 TAPPING KIT



SAVINGS
vs Buying Individually
\$191

KIT INCLUDES 14 PIECES

CAT40 Modular Shank	13200	ER16 Collet .236-.276	13804
Syncrolize SS Size 1 Adapter	13008	ER16 Collet .276-.315	13805
Size 1 Quick Change Collet	13600	ER16 Collet .315-.354	13806
ER16 Collet .079-.118	13800	ER16 Collet .354-.394	13807
ER16 Collet .118-.157	13801	T&C Straight Shank Holder	12000
ER16 Collet .157-.197	13802	Size 1 1/4" Rigid Tap Adapter	11606
ER16 Collet .197-.236	13803	Size 1 3/8" Torque Control Adapter	11806

\$599⁹⁵ EDP 11199A

Size 2 Rigid TAP ADAPTERS



SAVINGS
vs Buying Individually
\$25

KIT INCLUDES 5 PIECES

POPULAR SIZES	5/8 11619
3/8 11615	3/4 11621
1/2 11617	7/8 11623

\$188⁹⁵ EDP 11275A

ER25 Collet CAT40 CHUCKS



SAVINGS
vs Buying Individually
\$229

KIT INCLUDES 3 PIECES

2 1/2" 11008
3" 11009
8" 51016

\$349⁹⁵ EDP 11279A

BT40 TAPPING KIT



SAVINGS
vs Buying Individually
\$201

KIT INCLUDES 14 PIECES

BT40 Modular Shank	13203	ER16 Collet .236-.276	13804
Syncrolize SS Size 1 Adapter	13008	ER16 Collet .276-.315	13805
Size 1 Quick Change Collet	13600	ER16 Collet .315-.354	13806
ER16 Collet .079-.118	13800	ER16 Collet .354-.394	13807
ER16 Collet .118-.157	13801	T&C Straight Shank Holder	12000
ER16 Collet .157-.197	13802	Size 1 1/4" Rigid Tap Adapter	11606
ER16 Collet .197-.236	13803	Size 1 3/8" Torque Control Adapter	11806

\$599⁹⁵ EDP 11198A

Size 2 Torque TAP ADAPTERS



SAVINGS
vs Buying Individually
\$100

KIT INCLUDES 5 PIECES

POPULAR SIZES	5/8 11816
3/8 11812	3/4 11818
1/2 11814	7/8 11820

\$398⁹⁵ EDP 11276A

ER32 Collet CAT40 CHUCKS



SAVINGS
vs Buying Individually
\$239

KIT INCLUDES 3 PIECES

3" 51013
5" 11013
8" 51017

\$369⁹⁵ EDP 11280A

TOOLING PACKAGES



Standard - Premium - High Performance
CAT 40 Shank

Milling

Drilling

Tapping

Standard



SAVINGS
vs Buying Individually
\$465

10 Piece Set Includes

- | | |
|------------------|------------------|
| 2 - 1/4 EM 11060 | 1 - 5/8 EM 11073 |
| 2 - 3/8 EM 11061 | 2 - 3/4 EM 11063 |
| 2 - 1/2 EM 11062 | 1 - 1 EM 11075 |

\$649⁹⁵ EDP 11281A



SAVINGS
vs Buying Individually
\$253

5 Piece Set Includes

- | | |
|---------------|----------------|
| 1 - JKP L9680 | 2 - JT 11088 |
| 1 - JKP L9682 | 1 - ER16 11007 |

\$579⁹⁵ EDP 11284A



SAVINGS
vs Buying Individually
\$252

22 Piece Tension & Compression Set

- | | |
|------------------------------------|-----------|
| 1 - Set Rigid Tap Adapter Size 1 | 1 - 11050 |
| 1 - Set Rigid Tap Adapter Size 2 | 1 - 11052 |
| 1 - Set Torque Tap Adapters Size 1 | |
| 1 - Set Torque Tap Adapter Size 2 | |

\$1,569⁹⁵ EDP 11287A

Premium



SAVINGS
vs Buying Individually
\$675

10 Piece Set Includes

- | | |
|------------------|------------------|
| 2 - ER16 51013 | 1 - 5/8 EM 11073 |
| 3 - ER32 11012 | 1 - 3/4 EM 11063 |
| 2 - 1/2 EM 11062 | 1 - 1 EM 11075 |

\$799⁹⁵ EDP 11282A



SAVINGS
vs Buying Individually
\$407

7 Piece Set Includes

- | | |
|----------------|----------------|
| 1 - JKT L30532 | 2 - JT 11088 |
| 1 - JKT L30528 | 1 - JT 11089 |
| 1 - JKT L30530 | 1 - ER16 11007 |

\$888⁹⁵ EDP 11285A



SAVINGS
vs Buying Individually
\$200

24 Piece Rigid Set Includes

- | | |
|-----------|-----------------------------------|
| 2 - 11100 | 2 - Set Rigid Tap Adapters Size 1 |
| 2 - 11102 | 2 - Set Rigid Tap Adapters Size 2 |

\$1,247⁹⁵ EDP 11288A

Performance



SAVINGS
vs Buying Individually
\$649

20 Piece Set Includes

- | | |
|------------------|------------------|
| 3 - Weler 15023 | 2 - 3/4 RS 15062 |
| 2 - 1/4 RS 15057 | 2 - 1 RS 15064 |
| 2 - 3/8 RS 15065 | 2 - ER16 51013 |
| 2 - 1/2 RS 15060 | 3 - ER32 11012 |
| 2 - 5/8 RS 15061 | |

\$2,599⁹⁵ EDP 11283A



SAVINGS
vs Buying Individually
\$500

14 Piece Set Includes

- | | |
|------------------|------------------|
| 1 - HEXA L40016 | 1 - 1/2 RS 15060 |
| 1 - HEXA L40020 | 1 - 5/8 RS 15061 |
| 2 - HEXA L40024 | 1 - 3/4 RS 15062 |
| 2 - Weler 15023 | 1 - 1 RS 15064 |
| 1 - 1/4 RS 15057 | 2 - ER16 51013 |
| 1 - 3/8 RS 15065 | |

\$2,898⁹⁵ EDP 11286A



SAVINGS
vs Buying Individually
\$526

20 Piece Syncrolize Set Includes

- | | |
|-----------|-----------|
| 3 - 13004 | 1 - 13103 |
| 3 - 13013 | 3 - 13602 |
| 3 - 13600 | 1 - 13104 |
| 1 - 13100 | 1 - 13105 |
| 1 - 13101 | 1 - 13106 |
| 1 - 13102 | 1 - 13107 |

\$2,899⁹⁵ EDP 11289A









ER Collets not included in tooling packages. Standard & Coolant Tight individual pieces and sets can be found on pages 10 & 11



TOOLING PACKAGES

Standard - Premium - High Performance

CAT 50 Shank

	Milling	Drilling	Tapping																																		
Standard	 <p>SAVINGS vs Buying Individually \$691</p> <p>10 Piece Set Includes</p> <table border="0"> <tr> <td>2 - 3/8 EM 11140</td> <td>2 - 3/4 EM 11156</td> </tr> <tr> <td>2 - 1/2 EM 11148</td> <td>2 - 1 EM 11163</td> </tr> <tr> <td>1 - 5/8 EM 11152</td> <td>1 - 1 1/4 EM 11166</td> </tr> </table> <p>\$899⁹⁵ EDP 11290A</p>	2 - 3/8 EM 11140	2 - 3/4 EM 11156	2 - 1/2 EM 11148	2 - 1 EM 11163	1 - 5/8 EM 11152	1 - 1 1/4 EM 11166	 <p>SAVINGS vs Buying Individually \$357</p> <p>5 Piece Set Includes</p> <table border="0"> <tr> <td>1 - JKP L9680</td> <td>2 - JT 11090</td> </tr> <tr> <td>1 - JKP L9682</td> <td>1 - ER16 11027</td> </tr> </table> <p>\$759⁹⁵ EDP 11293A</p>	1 - JKP L9680	2 - JT 11090	1 - JKP L9682	1 - ER16 11027	 <p>SAVINGS vs Buying Individually \$403</p> <p>22 Piece Tension & Compression Set</p> <table border="0"> <tr> <td>1 - Set Rigid Tap Adapters Size 1</td> <td>1 - 11051</td> </tr> <tr> <td>1 - Set Rigid Tap Adapters Size 2</td> <td>1 - 11053</td> </tr> <tr> <td>1 - Set Torque Tap Adapters Size 1</td> <td></td> </tr> <tr> <td>1 - Set Torque Tap Adapters Size 2</td> <td></td> </tr> </table> <p>\$1,499⁹⁵ EDP 11296A</p>	1 - Set Rigid Tap Adapters Size 1	1 - 11051	1 - Set Rigid Tap Adapters Size 2	1 - 11053	1 - Set Torque Tap Adapters Size 1		1 - Set Torque Tap Adapters Size 2																	
	2 - 3/8 EM 11140	2 - 3/4 EM 11156																																			
	2 - 1/2 EM 11148	2 - 1 EM 11163																																			
1 - 5/8 EM 11152	1 - 1 1/4 EM 11166																																				
1 - JKP L9680	2 - JT 11090																																				
1 - JKP L9682	1 - ER16 11027																																				
1 - Set Rigid Tap Adapters Size 1	1 - 11051																																				
1 - Set Rigid Tap Adapters Size 2	1 - 11053																																				
1 - Set Torque Tap Adapters Size 1																																					
1 - Set Torque Tap Adapters Size 2																																					
Premium	 <p>SAVINGS vs Buying Individually \$833</p> <p>10 Piece Set Includes</p> <table border="0"> <tr> <td>2 - ER16 11025</td> <td>1 - 5/8 EM 11152</td> </tr> <tr> <td>3 - ER32 11031</td> <td>1 - 3/4 EM 11156</td> </tr> <tr> <td>2 - 1/2 EM 11148</td> <td>1 - 1 EM 11163</td> </tr> </table> <p>\$1,099⁹⁵ EDP 11291A</p>	2 - ER16 11025	1 - 5/8 EM 11152	3 - ER32 11031	1 - 3/4 EM 11156	2 - 1/2 EM 11148	1 - 1 EM 11163	 <p>SAVINGS vs Buying Individually \$506</p> <p>7 Piece Set Includes</p> <table border="0"> <tr> <td>1 - JKT L30532</td> <td>2 - JT 11090</td> </tr> <tr> <td>1 - JKT L30528</td> <td>1 - JT 11091</td> </tr> <tr> <td>1 - JKT L30530</td> <td>1 - ER16 11027</td> </tr> </table> <p>\$1,169⁹⁵ EDP 11294A</p>	1 - JKT L30532	2 - JT 11090	1 - JKT L30528	1 - JT 11091	1 - JKT L30530	1 - ER16 11027	 <p>SAVINGS vs Buying Individually \$168</p> <p>24 Piece Rigid Set Includes</p> <table border="0"> <tr> <td>2 - 11101</td> <td></td> </tr> <tr> <td>2 - 11103</td> <td></td> </tr> <tr> <td>2 - Set Rigid Tap Adapters Size 1</td> <td></td> </tr> <tr> <td>2 - Set Rigid Tap Adapters Size 2</td> <td></td> </tr> </table> <p>\$1,499⁹⁵ EDP 11297A</p>	2 - 11101		2 - 11103		2 - Set Rigid Tap Adapters Size 1		2 - Set Rigid Tap Adapters Size 2															
	2 - ER16 11025	1 - 5/8 EM 11152																																			
	3 - ER32 11031	1 - 3/4 EM 11156																																			
2 - 1/2 EM 11148	1 - 1 EM 11163																																				
1 - JKT L30532	2 - JT 11090																																				
1 - JKT L30528	1 - JT 11091																																				
1 - JKT L30530	1 - ER16 11027																																				
2 - 11101																																					
2 - 11103																																					
2 - Set Rigid Tap Adapters Size 1																																					
2 - Set Rigid Tap Adapters Size 2																																					
Performance	 <p>SAVINGS vs Buying Individually \$729</p> <p>20 Piece Set Includes</p> <table border="0"> <tr> <td>3 - Weler 15031</td> <td>2 - 3/4 RS 15062</td> </tr> <tr> <td>2 - 1/4 RS 15057</td> <td>2 - 1 RS 15064</td> </tr> <tr> <td>2 - 3/8 RS 15065</td> <td>2 - ER16 11025</td> </tr> <tr> <td>2 - 1/2 RS 15060</td> <td>3 - ER32 11031</td> </tr> <tr> <td>2 - 5/8 RS 15061</td> <td></td> </tr> </table> <p>\$2,999⁹⁵ EDP 11292A</p>	3 - Weler 15031	2 - 3/4 RS 15062	2 - 1/4 RS 15057	2 - 1 RS 15064	2 - 3/8 RS 15065	2 - ER16 11025	2 - 1/2 RS 15060	3 - ER32 11031	2 - 5/8 RS 15061		 <p>SAVINGS vs Buying Individually \$619</p> <p>14 Piece Set Includes</p> <table border="0"> <tr> <td>1 - HEXA L40018</td> <td>1 - 1/2 RS 15060</td> </tr> <tr> <td>1 - HEXA L40022</td> <td>1 - 5/8 RS 15061</td> </tr> <tr> <td>2 - HEXA L40026</td> <td>1 - 3/4 RS 15062</td> </tr> <tr> <td>2 - Weler 15031</td> <td>1 - 1 RS 15064</td> </tr> <tr> <td>1 - 1/4 RS 15057</td> <td>2 - ER16 11027</td> </tr> <tr> <td>1 - 3/8 RS 15065</td> <td></td> </tr> </table> <p>\$3,499⁹⁵ EDP 11295A</p>	1 - HEXA L40018	1 - 1/2 RS 15060	1 - HEXA L40022	1 - 5/8 RS 15061	2 - HEXA L40026	1 - 3/4 RS 15062	2 - Weler 15031	1 - 1 RS 15064	1 - 1/4 RS 15057	2 - ER16 11027	1 - 3/8 RS 15065		 <p>SAVINGS vs Buying Individually \$506</p> <p>20 Piece Syncrolize Set Includes</p> <table border="0"> <tr> <td>3 - 13005</td> <td>1 - 13103</td> </tr> <tr> <td>3 - 13014</td> <td>3 - 13602</td> </tr> <tr> <td>3 - 13600</td> <td>1 - 13104</td> </tr> <tr> <td>1 - 13100</td> <td>1 - 13105</td> </tr> <tr> <td>1 - 13101</td> <td>1 - 13106</td> </tr> <tr> <td>1 - 13102</td> <td>1 - 13107</td> </tr> </table> <p>\$3,069⁹⁵ EDP 11298A</p>	3 - 13005	1 - 13103	3 - 13014	3 - 13602	3 - 13600	1 - 13104	1 - 13100	1 - 13105	1 - 13101	1 - 13106	1 - 13102	1 - 13107
	3 - Weler 15031	2 - 3/4 RS 15062																																			
	2 - 1/4 RS 15057	2 - 1 RS 15064																																			
2 - 3/8 RS 15065	2 - ER16 11025																																				
2 - 1/2 RS 15060	3 - ER32 11031																																				
2 - 5/8 RS 15061																																					
1 - HEXA L40018	1 - 1/2 RS 15060																																				
1 - HEXA L40022	1 - 5/8 RS 15061																																				
2 - HEXA L40026	1 - 3/4 RS 15062																																				
2 - Weler 15031	1 - 1 RS 15064																																				
1 - 1/4 RS 15057	2 - ER16 11027																																				
1 - 3/8 RS 15065																																					
3 - 13005	1 - 13103																																				
3 - 13014	3 - 13602																																				
3 - 13600	1 - 13104																																				
1 - 13100	1 - 13105																																				
1 - 13101	1 - 13106																																				
1 - 13102	1 - 13107																																				

Mix & Match to create the tooling package that best suits your needs.

Find Technical Information at www.SCM-America.com